

City of Petaluma, California

PAVEMENT RESTORATION 22/23

GARFIELD DR.

C16102248

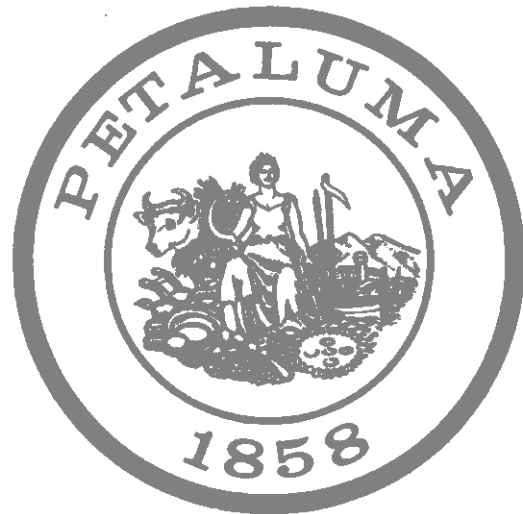

MAYOR
Kevin McDonnell

COUNCIL MEMBER
Brian Barnacle
Janice Cader-Thompson
Mike Healy
Karen Nau
Dennis Pocekay
John Shribbs

CITY MANAGER
Peggy Flynn

PUBLIC WORKS & UTILITIES DIRECTOR
Christopher Bolt

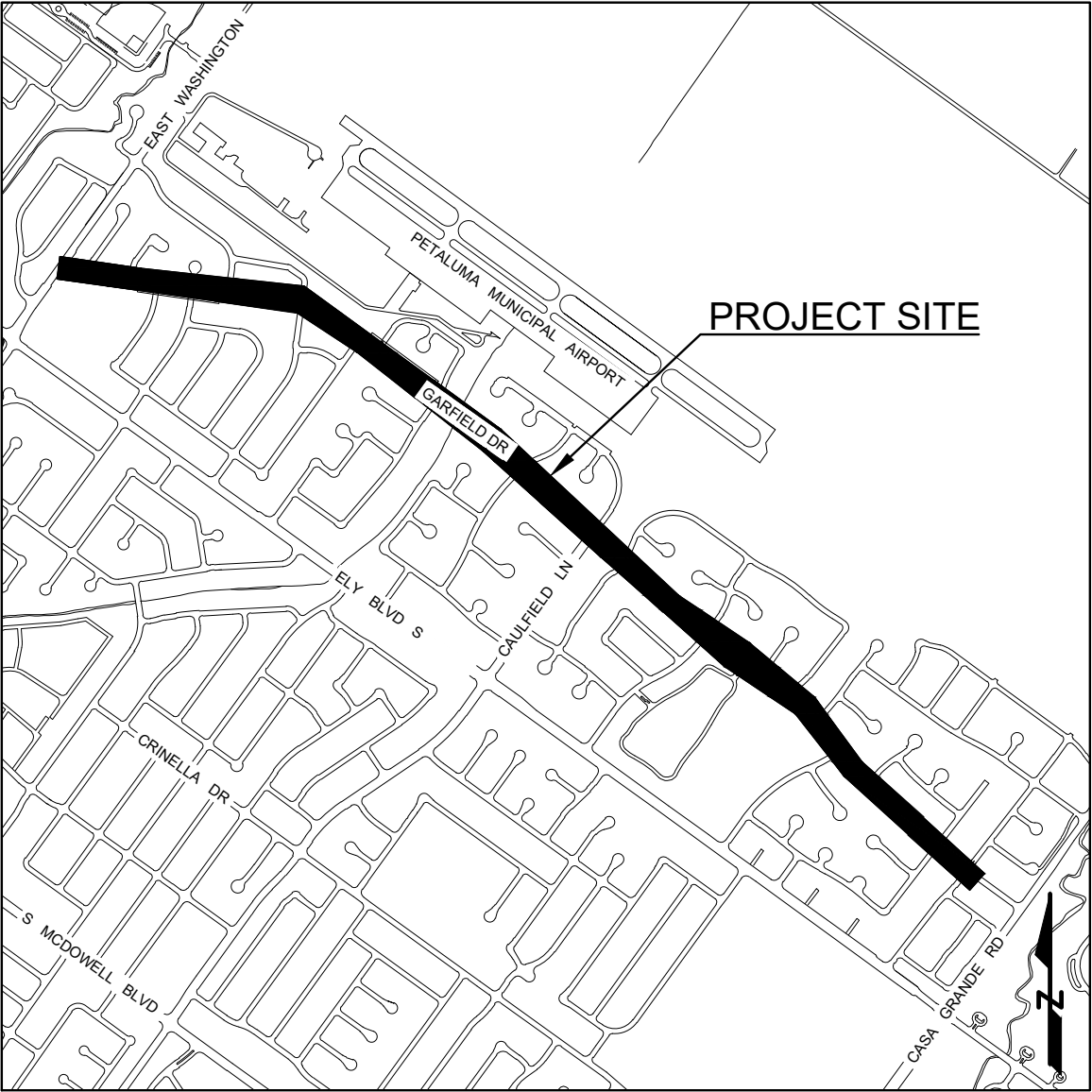

LOCATION MAP
SCALE: N.T.S.

RECORD PLAN

I _____ HEREBY STATE THAT THESE RECORD PLAN CHANGES ARE COMPLETE FROM INFORMATION FURNISHED BY THE PROJECT CONTRACTOR, SOILS ENGINEER AND MY OFFICE. I HEREBY STATE THAT TO THE BEST OF MY KNOWLEDGE THE THE WORK WAS DONE IN ACCORDANCE WITH THE FINAL APPROVED PLANS. THE ENGINEER AND THE CITY WILL NOT BE RESPONSIBLE FOR ANY ERRORS OR OMISSIONS WHICH HAVE BEEN INCORPORATED INTO THIS DOCUMENT AS A RESULT. FIELD VERIFICATION OF CRITICAL FACTS AND DATA SHOULD BE MADE IF THESE DOCUMENTS ARE TO BE USED AS A BASIS FOR FUTURE WORK. ENGINEER'S SIGNATURE _____ DATE: _____

SHEET INDEX

G1	COVER SHEET
G2	GENERAL NOTES, SURVEY CONTROL
G3	ABBREVIATIONS, SYMBOLS, REVISIONS
P1	STA 1+00 TO STA 6+50
P2	STA 6+50 TO STA 12+50
P3	STA 12+50 TO STA 17+50
P4	STA 17+50 TO STA 23+50
P5	STA 23+50 TO STA 29+50
P6	STA 29+50 TO STA 35+00
P7	STA 35+00 TO STA 41+00
P8	STA 41+00 TO STA 46+50
P9	STA 46+50 TO STA 52+50
P10	STA 52+50 TO STA 58+50
P11	STA 58+50 TO STA 64+50
P12	STA 64+50 TO STA 70+50
P13	STA 70+50 TO STA 76+50
P14	STA 76+50 TO STA 79+86
D1	SECTIONS AND DETAILS

■ ALL PROJECT PLANS HAVE BEEN PREPARED AND REVIEWED TO COMPLY WITH CURRENT AMERICANS WITH DISABILITIES ACT (ADA) REQUIREMENTS AND/OR THE CALIFORNIA BUILDING STANDARDS CODE (CBCS).

THESE PROJECT PLANS CONTAIN ELEMENT(S) THAT ARE NOT "TECHNICALLY FEASIBLE" AND/OR CAN'T MEET THE APPLICABLE CBCS BECAUSE IT WOULD CREATE AN "UNREASONABLE HARDSHIP." PLEASE SEE THE WRITTEN ANALYSIS SUPPORTING THIS DETERMINATION FILED UNDER THE PROJECT FILE.

DESIGNED BY Jeff Stutsman 1/25/23
SIGNATURE _____ DATE _____

APPROVED BY: Jeff Stutsman 1/25/23
Jeff Stutsman P.E. C79843
City Engineer

DESIGNED BY: George Howard 1/25/23
George Howard
Assistant Engineer II

	SIGNATURE	DATE
CITY ENGINEER		
ENGINEERING MANAGER		
FIRE MARSHAL		
PARKS		
PLANNING		
POLICE		
UTILITY MANAGER		

DATE: JANUARY 2023
DESIGNED BY: GH
DRAWN BY: GH
CHECKED BY: JAS

PROJECT NO.
C16102248

CITY OF PETALUMA
PUBLIC WORKS & UTILITIES
202 N. McDowell Blvd., PETALUMA, CALIFORNIA, 94954
PH. 707-778-4546 FAX. 707-778-4508

PAVEMENT RESTORATION 22/23
GARFIELD DR.
TITLE PAGE

SHEET
G1
1 OF 18

GENERAL NOTES

1.
- CONTRACTOR SHALL FIELD VERIFY THE HORIZONTAL AND VERTICAL LOCATION OF ALL EXISTING UTILITIES BY POT-HOLING OR OTHER DIRECT INSPECTION METHOD PRIOR TO COMMENCING WORK.
2.
- THE CONTRACTOR SHALL REPLACE THE SEWER MAIN AND LATERALS PRIOR TO INSTALLATION OF THE NEW WATER MAIN.
3.
- UNDERGROUND UTILITIES MAY NOT BE SHOWN ON THE PLANS AND MUST BE LOCATED BY THE CONTRACTOR PRIOR START OF PROPOSED WORK.
4.
- ALL FRAMES AND COVERS MUST BE ADJUSTED TO FINISH GRADE WITHIN 2 DAYS AFTER FINAL PAVING.
5.
- THE CONTRACTOR SHALL NOTE ALL APPROVED FIELD CHANGES AND OTHER OCCURRENCES AND SUBMIT A FULL SIZE COMPLETE CONSTRUCTION "RECORD DRAWING" SET NOTED AND DATED ON THE DRAWINGS TO THE PROJECT ENGINEER PRIOR TO ACCEPTANCE OF THE WORK.
6.
- IT IS THE RESPONSIBILITY OF THE CONTRACTOR TO ENSURE ALL MATERIAL AND WORKMANSHIP FULLY CONFORMS TO THE SPECIFICATIONS, STANDARDS AND ORDINANCES OF THE CITY OF PETALUMA.
7.
- ALL EROSION AND SEDIMENT CONTROL MATERIALS AND METHODS SHALL COMPLY WITH THE CALIFORNIA REGIONAL WATER QUALITY CONTROL BOARD, SAN FRANCISCO BAY REGION, EROSION AND SEDIMENT CONTROL MANUAL..
8.
- THE CONTRACTOR SHALL CONTACT UNDERGROUND SERVICE ALERT (USA) AND VERIFY UTILITY MARKINGS PRIOR TO ANY EXCAVATION. 1-800-227-2600

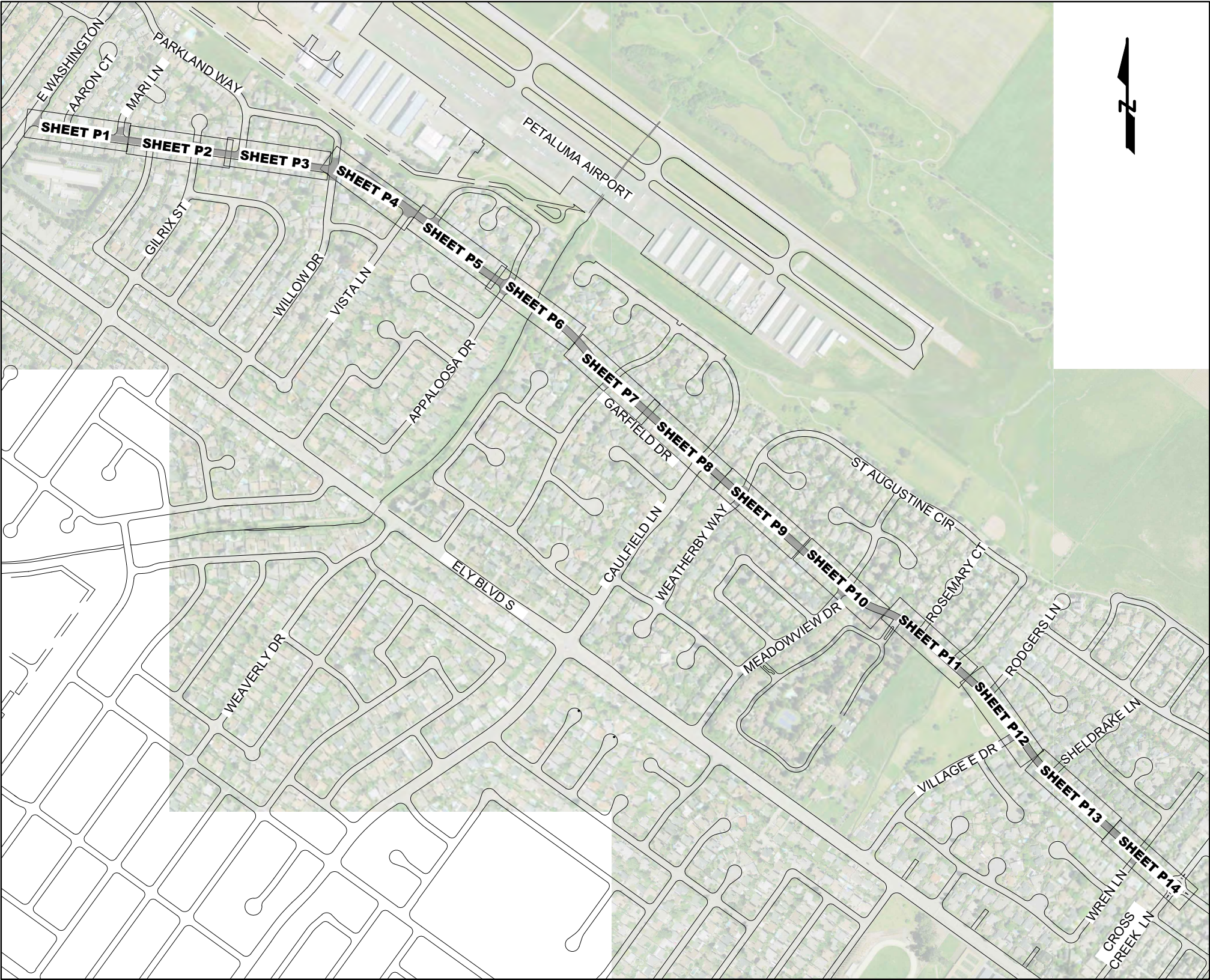

SURVEY CONTROL DATA

1.
- THESE PLANS WERE PREPARED USING COMPUTER ASSISTED, AERIAL PHOTOGRAMETRIC MAPPING. THE MERIDIAN AND GRID IS BASED ON THE CALIFORNIA COORDINATE SYSTEM ZONE II, NAD 1983.

DATE: JANUARY 2023
DESIGNED BY: GH
DRAWN BY: GH
CHECKED BY: JAS

PROJECT NO.
C16102248



CITY OF PETALUMA
PUBLIC WORKS & UTILITIES
202 N. McDowell Blvd., PETALUMA, CALIFORNIA, 94954
PH. 707-778-4546 FAX. 707-778-4508



PAVEMENT RESTORATION 22/23
GARFIELD DR.
KEY PLAN, GENERAL NOTES, SURVEY CONTROL

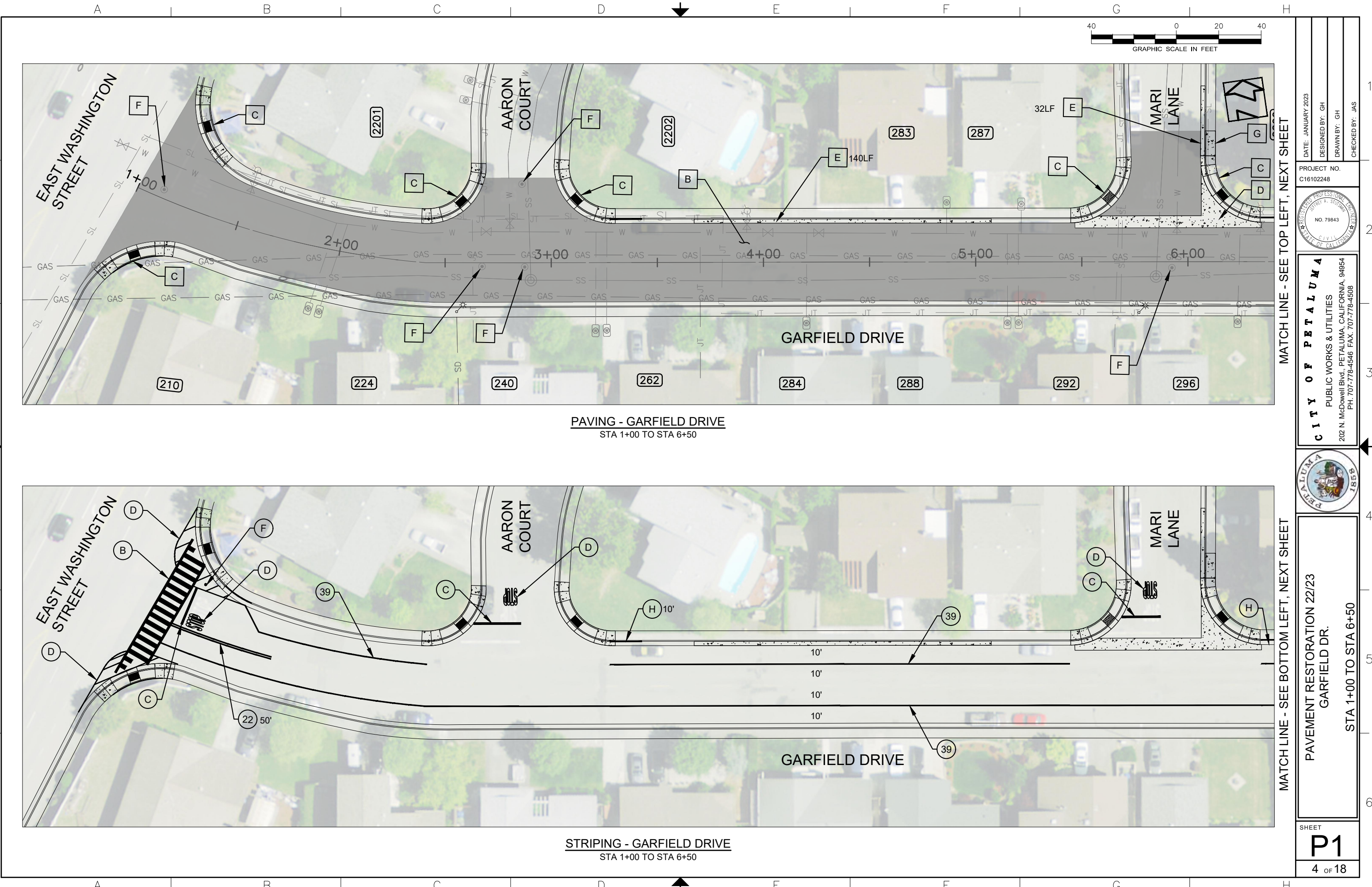

PAVING - GARFIELD DRIVE
STA 1+00 TO STA 6+50

STRIPING - GARFIELD DRIVE
STA 1+00 TO STA 6+50

MATCH LINE - SEE TOP LEFT, NEXT SHEET

MATCH LINE - SEE BOTTOM LEFT, NEXT SHEET

DATE: JANUARY 2023	DESIGNED BY: GH	DRAWN BY: GH	CHECKED BY: JAS
PROJECT NO. C16102248			
			
CITY OF PETALUMA PUBLIC WORKS & UTILITIES 202 N. McDowell Blvd., PETALUMA, CALIFORNIA, 94954 PH. 707-778-4546 FAX. 707-778-4508			
PAVEMENT RESTORATION 22/23 GARFIELD DR. STA 1+00 TO STA 6+50			
SHEET P1 4 OF 18			

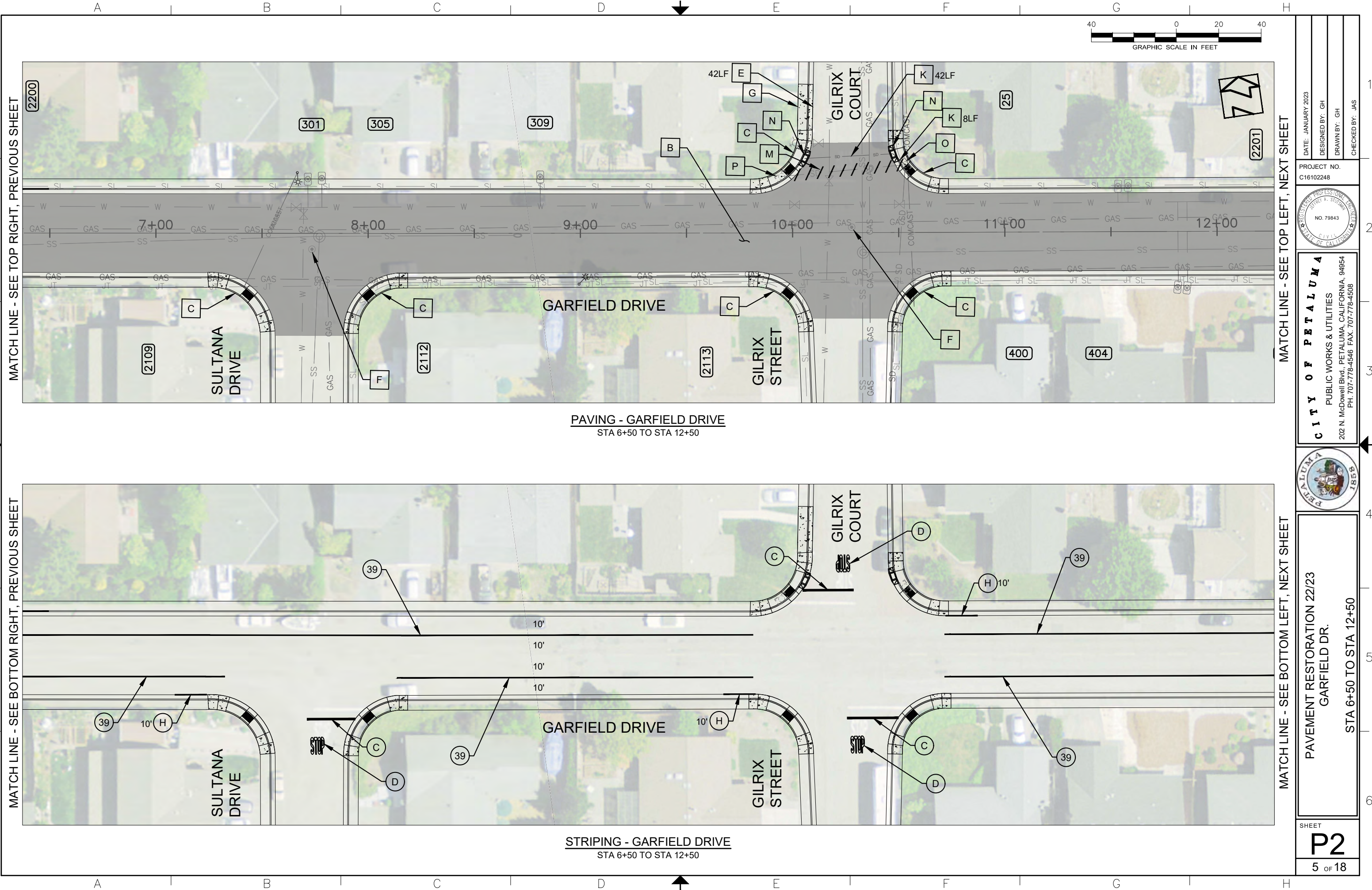

DATE: JANUARY 2023
DESIGNED BY: GH
DRAWN BY: GH
CHECKED BY: JAS

PROJECT NO.
C16102248

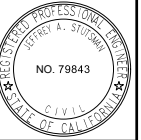

CITY OF PETALUMA
PUBLIC WORKS & UTILITIES
202 N. McDowell Blvd., PETALUMA, CALIFORNIA, 94954
PH. 707-778-4546 FAX. 707-778-4508



PAVEMENT RESTORATION 22/23
GARFIELD DR.
STA 6+50 TO STA 12+50

SHEET
P2
5 OF 18



MATCH LINE - SEE TOP RIGHT, PREVIOUS SHEET

MATCH LINE - SEE TOP LEFT, NEXT SHEET

MATCH LINE - SEE BOTTOM RIGHT, PREVIOUS SHEET

MATCH LINE - SEE BOTTOM LEFT, NEXT SHEET

DATE: JANUARY 2023	DESIGNED BY: GH	DRAWN BY: GH	CHECKED BY: JAS
PROJECT NO. C16102248			
CITY OF PETALUMA PUBLIC WORKS & UTILITIES 202 N. McDowell Blvd., PETALUMA, CALIFORNIA, 94954 PH. 707-778-4546 FAX. 707-778-4508			
PAVEMENT RESTORATION 22/23 GARFIELD DR. STA 12+50 TO STA 17+50			
SHEET P3 6 OF 18			

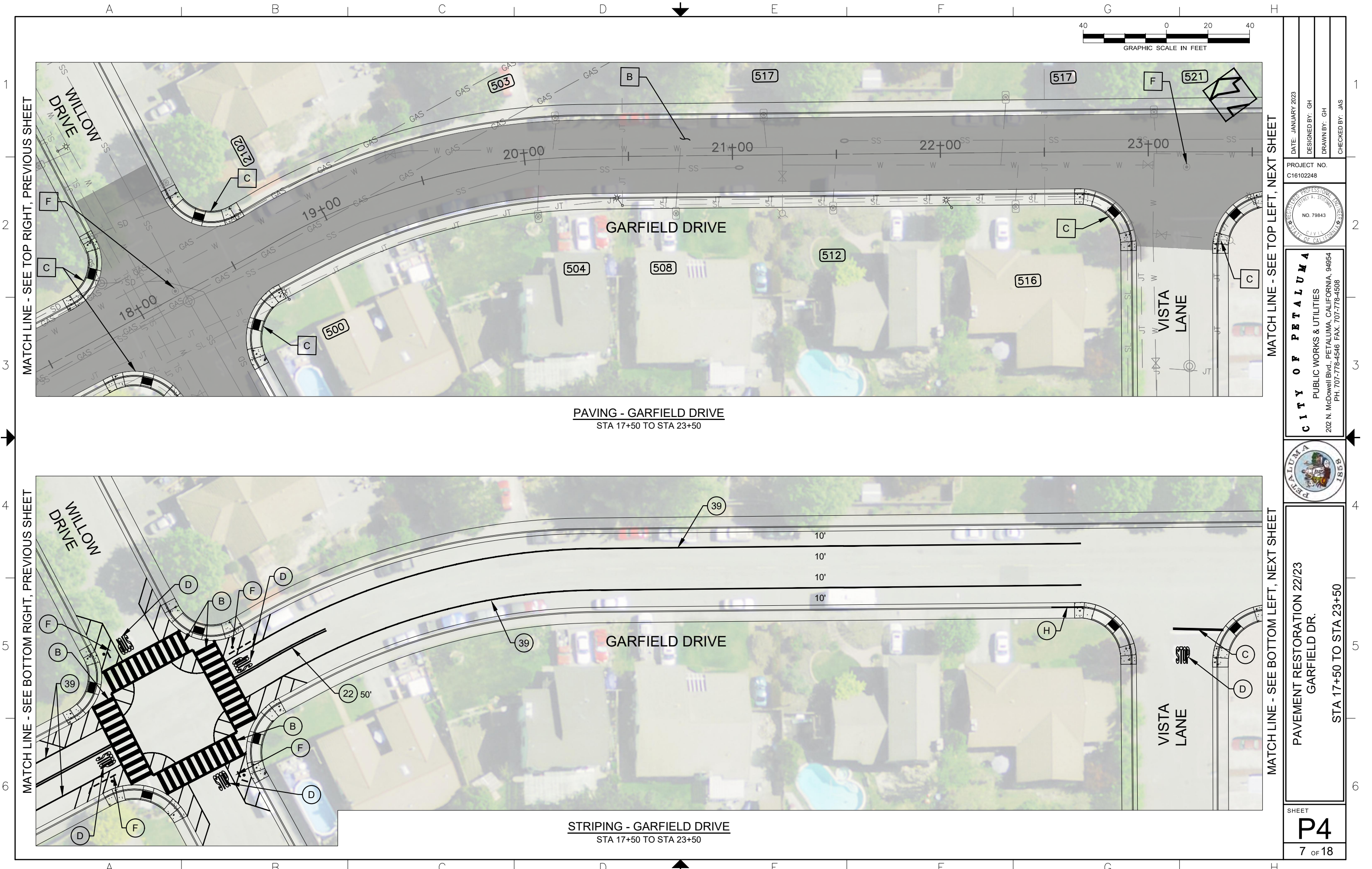

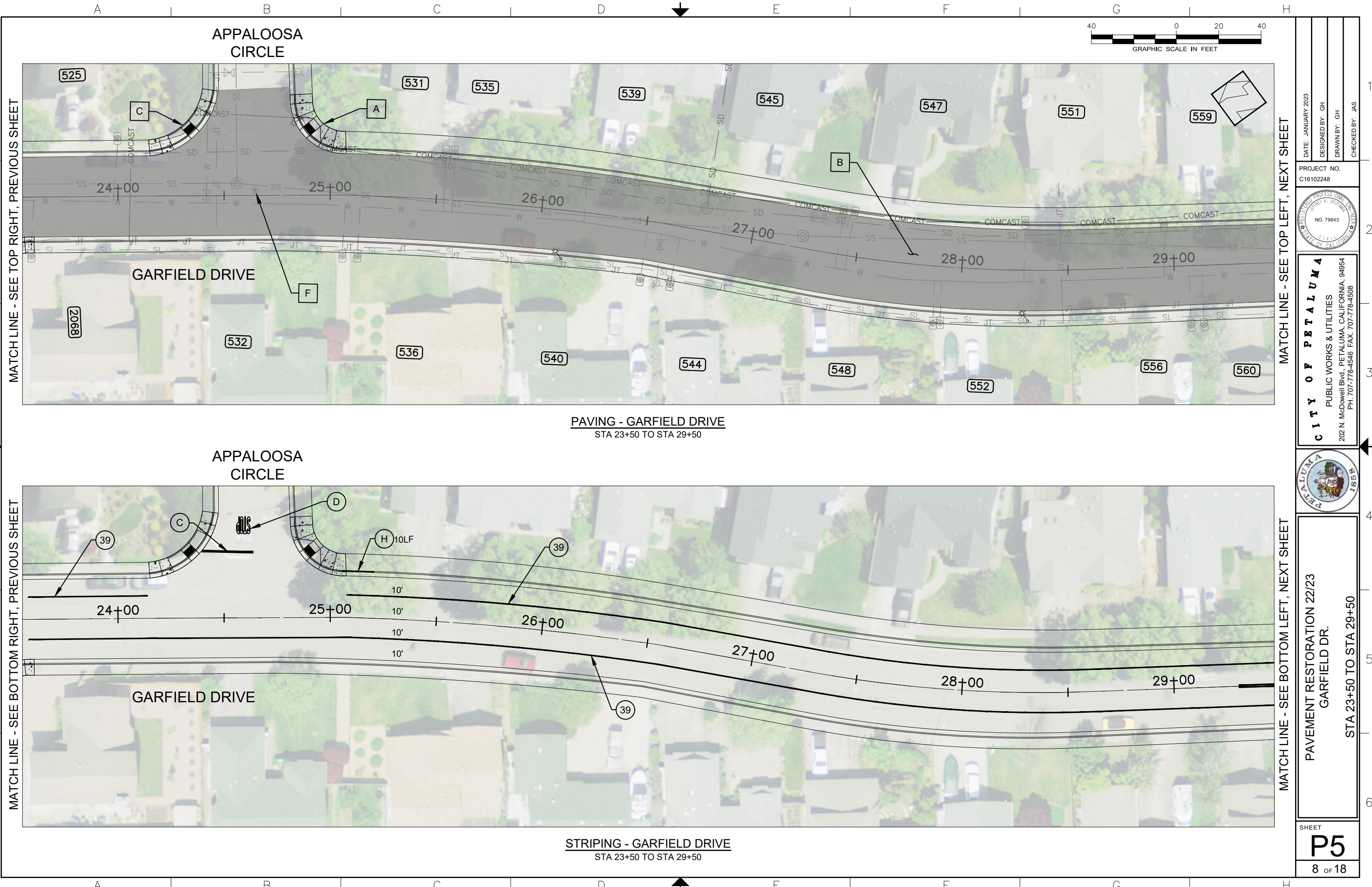

PAVING - GARFIELD DRIVE
STA 23+50 TO STA 29+50

STRIPING - GARFIELD DRIVE
STA 23+50 TO STA 29+50

DATE: JANUARY 2023	DESIGNED BY: GH	DRAWN BY: GH	CHECKED BY: JAS
PROJECT NO. C16102248			
			
CITY OF PETALUMA PUBLIC WORKS & UTILITIES 202 N. McDowell Blvd., PETALUMA, CALIFORNIA, 94954 PH. 707-778-4546 FAX. 707-778-4508			
			
PAVEMENT RESTORATION 22/23 GARFIELD DR. STA 23+50 TO STA 29+50			
SHEET P5 8 OF 18			

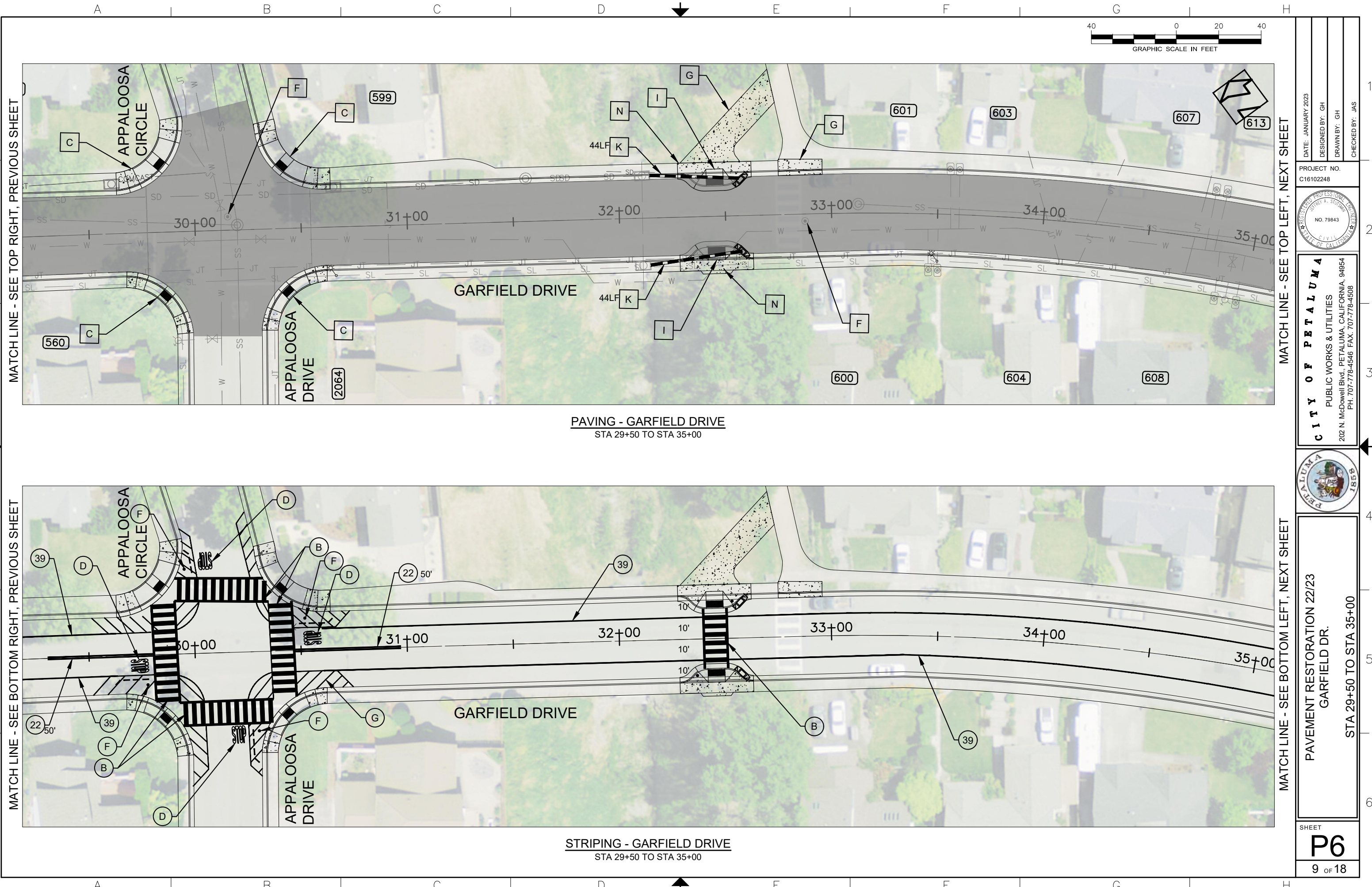

PAVING - GARFIELD DRIVE
STA 29+50 TO STA 35+00

STRIPING - GARFIELD DRIVE
STA 29+50 TO STA 35+00

MATCH LINE - SEE TOP LEFT, NEXT SHEET

MATCH LINE - SEE BOTTOM LEFT, NEXT SHEET

DATE: JANUARY 2023
DESIGNED BY: GH
DRAWN BY: GH
CHECKED BY: JAS

PROJECT NO.
C16102248



CITY OF PETALUMA
PUBLIC WORKS & UTILITIES
202 N. McDowell Blvd., PETALUMA, CALIFORNIA, 94954
PH. 707-778-4546 FAX. 707-778-4508



PAVEMENT RESTORATION 22/23
GARFIELD DR.
STA 29+50 TO STA 35+00

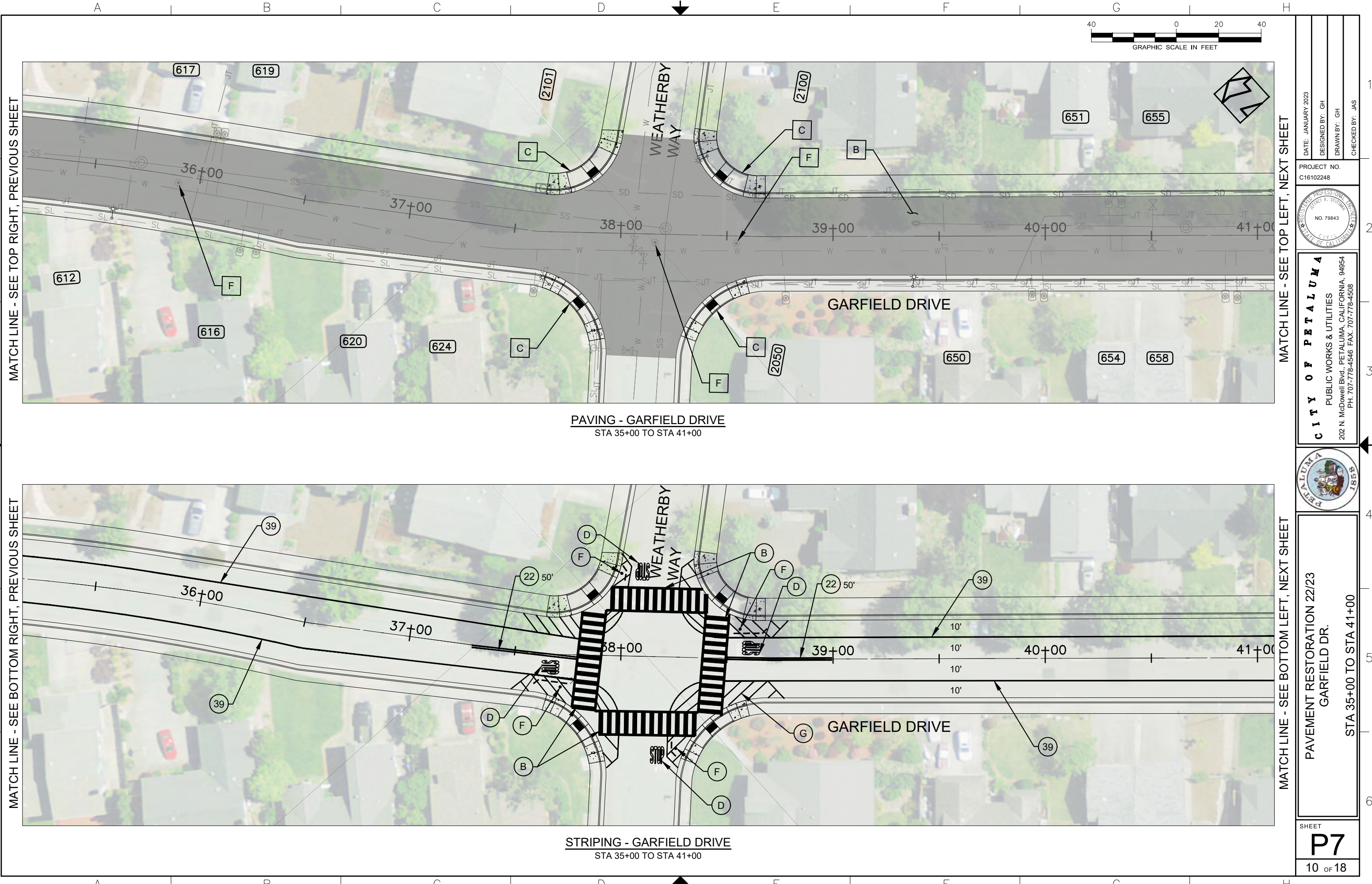

PAVING - GARFIELD DRIVE
STA 35+00 TO STA 41+00

STRIPING - GARFIELD DRIVE
STA 35+00 TO STA 41+00

DATE: JANUARY 2023
DESIGNED BY: GH
DRAWN BY: GH
CHECKED BY: JAS

PROJECT NO.
C16102248



CITY OF PETALUMA
PUBLIC WORKS & UTILITIES
202 N. McDowell Blvd., PETALUMA, CALIFORNIA, 94954
PH. 707-778-4546 FAX. 707-778-4508



PAVEMENT RESTORATION 22/23
GARFIELD DR.
STA 35+00 TO STA 41+00

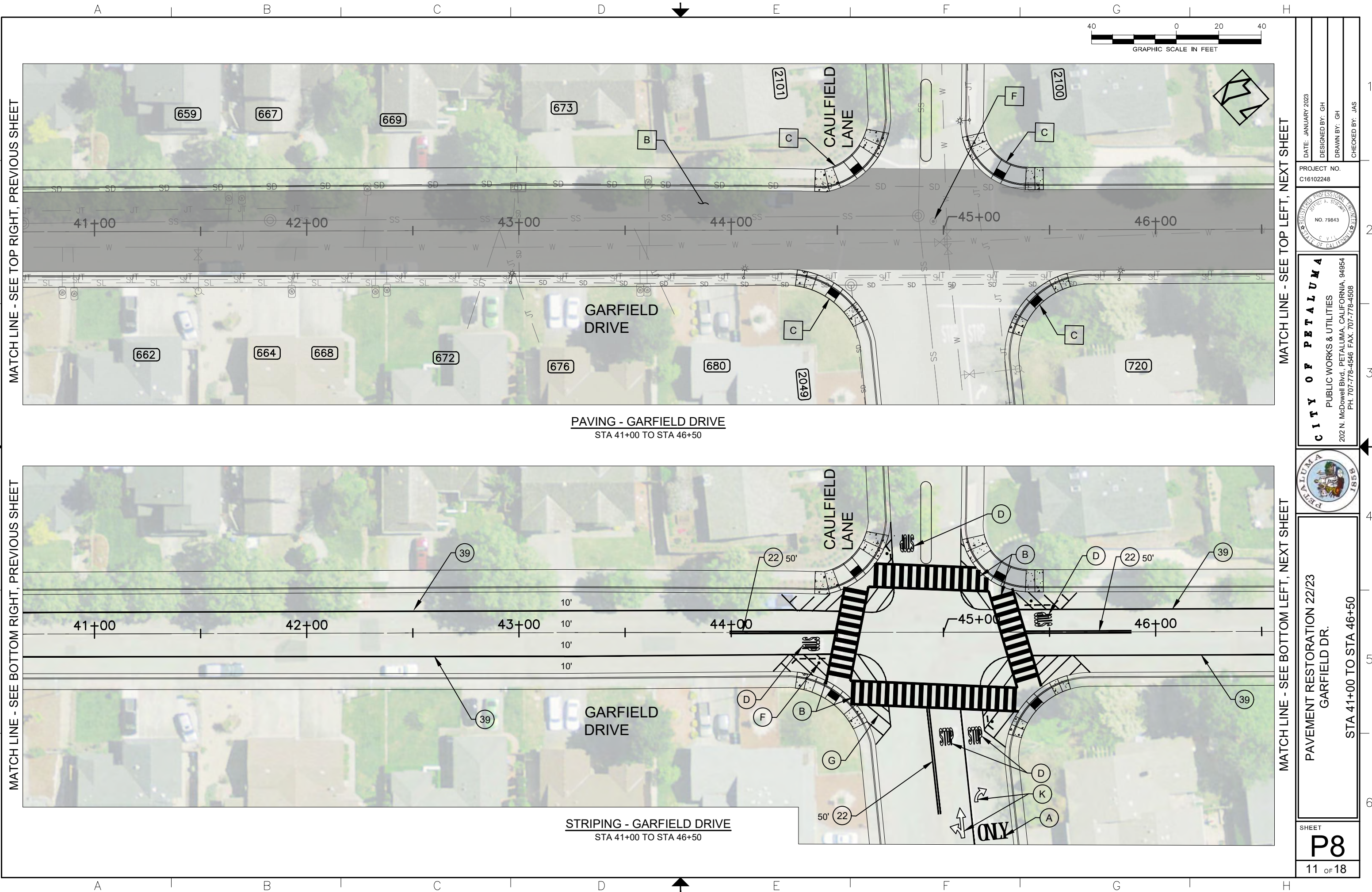

DATE: JANUARY 2023
DESIGNED BY: GH
DRAWN BY: GH
CHECKED BY: JAS

PROJECT NO.
C16102248

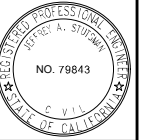

CITY OF PETALUMA
PUBLIC WORKS & UTILITIES
202 N. McDowell Blvd., PETALUMA, CALIFORNIA, 94954
PH. 707-778-4546 FAX. 707-778-4508



PAVEMENT RESTORATION 22/23
GARFIELD DR.
STA 41+00 TO STA 46+50

SHEET
P8
11 OF 18

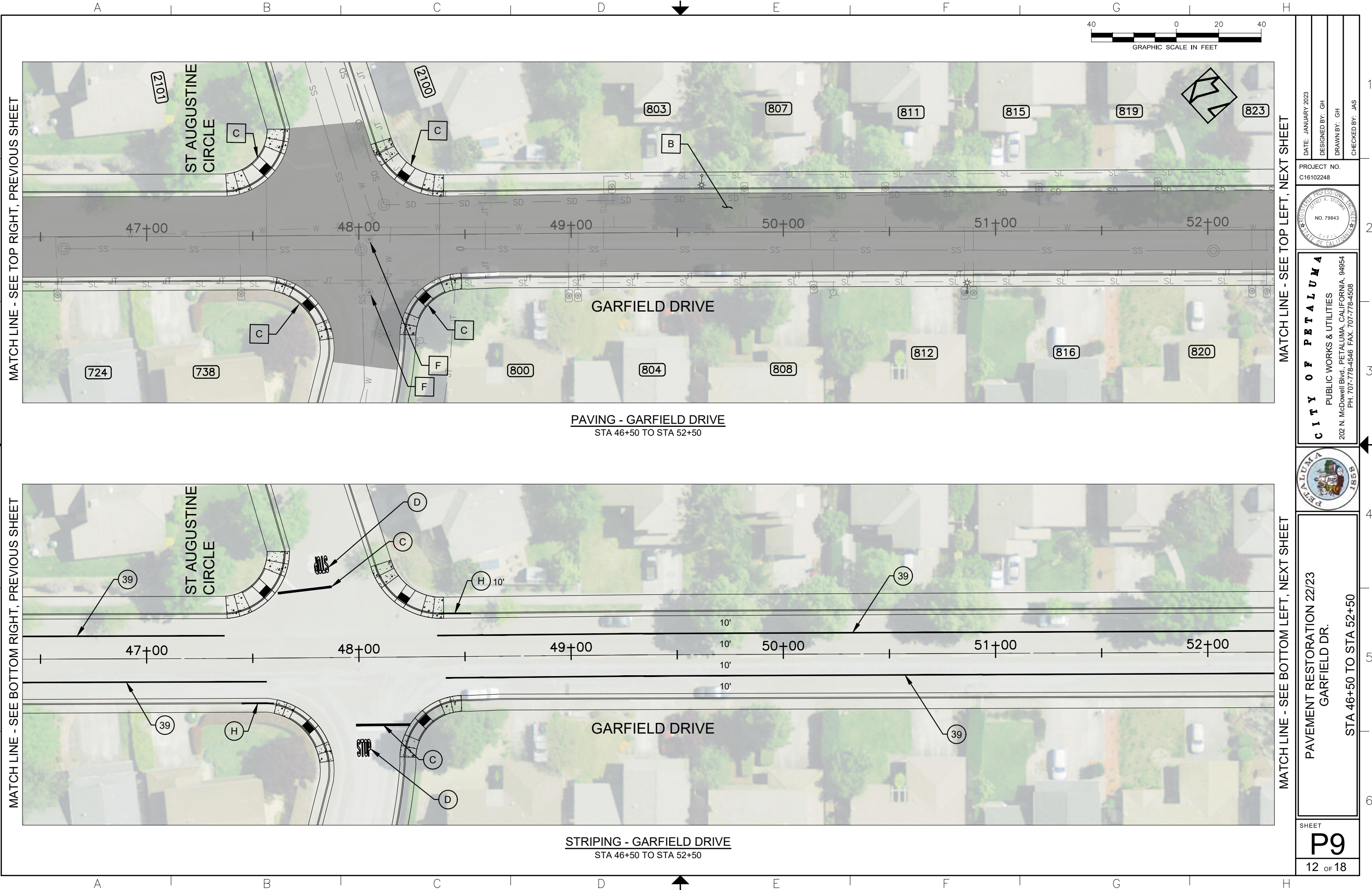

PAVING - GARFIELD DRIVE
STA 46+50 TO STA 52+50

STRIPING - GARFIELD DRIVE
STA 46+50 TO STA 52+50

DATE: JANUARY 2023
DESIGNED BY: GH
DRAWN BY: GH
CHECKED BY: JAS

PROJECT NO.
C16102248



CITY OF PETALUMA
PUBLIC WORKS & UTILITIES
202 N. McDowell Blvd., PETALUMA, CALIFORNIA, 94954
PH. 707-778-4546 FAX. 707-778-4508



PAVEMENT RESTORATION 22/23
GARFIELD DR.
STA 46+50 TO STA 52+50

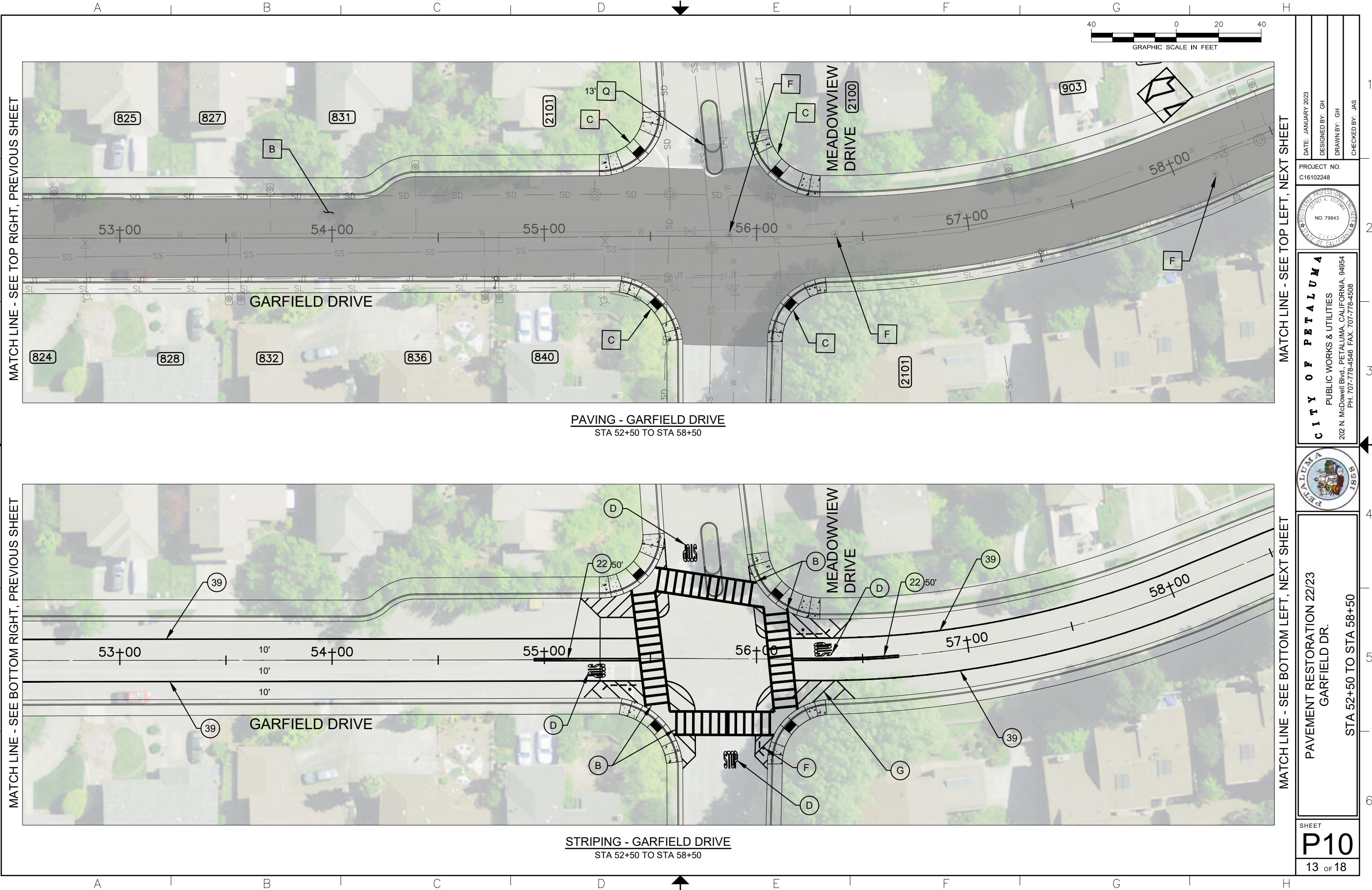

PAVING - GARFIELD DRIVE
STA 52+50 TO STA 58+50

STRIPING - GARFIELD DRIVE
STA 52+50 TO STA 58+50

MATCH LINE - SEE TOP LEFT, PREVIOUS SHEET

MATCH LINE - SEE BOTTOM LEFT, NEXT SHEET

DATE: JANUARY 2023
DESIGNED BY: GH
DRAWN BY: GH
CHECKED BY: JAS

PROJECT NO.
C16102248



CITY OF PETALUMA
PUBLIC WORKS & UTILITIES
202 N. McDowell Blvd., PETALUMA, CALIFORNIA, 94954
PH. 707-778-4546 FAX. 707-778-4508



PAVEMENT RESTORATION 22/23
GARFIELD DR.
STA 52+50 TO STA 58+50

SHEET
P10
13 OF 18

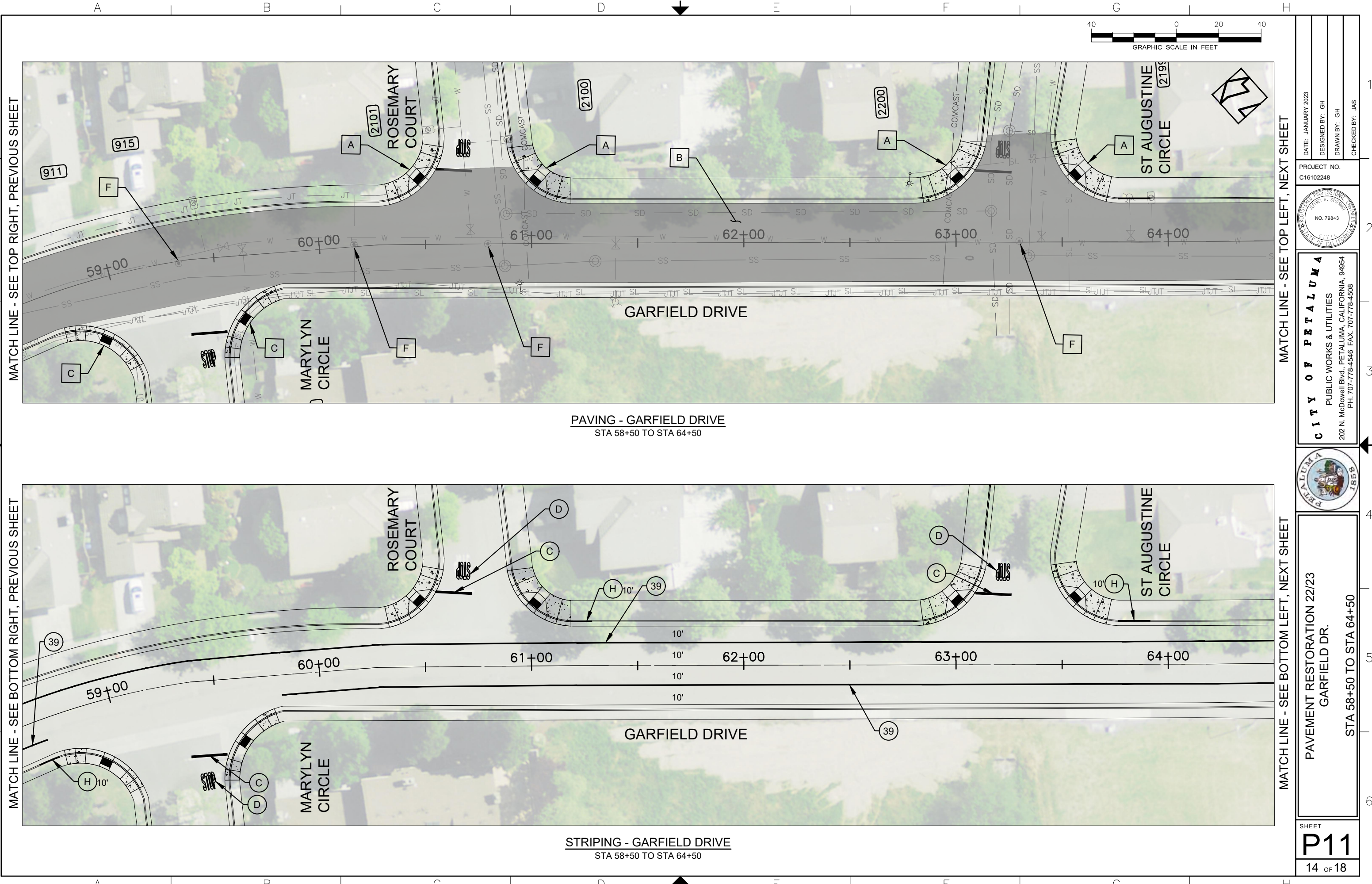

DATE: JANUARY 2023
DESIGNED BY: GH
DRAWN BY: GH
CHECKED BY: JAS

PROJECT NO.
C16102248

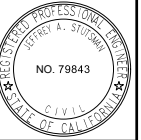

CITY OF PETALUMA
PUBLIC WORKS & UTILITIES
202 N. McDowell Blvd., PETALUMA, CALIFORNIA, 94954
PH. 707-778-4546 FAX. 707-778-4508



PAVEMENT RESTORATION 22/23
GARFIELD DR.
STA 58+50 TO STA 64+50

SHEET
P11
14 OF 18

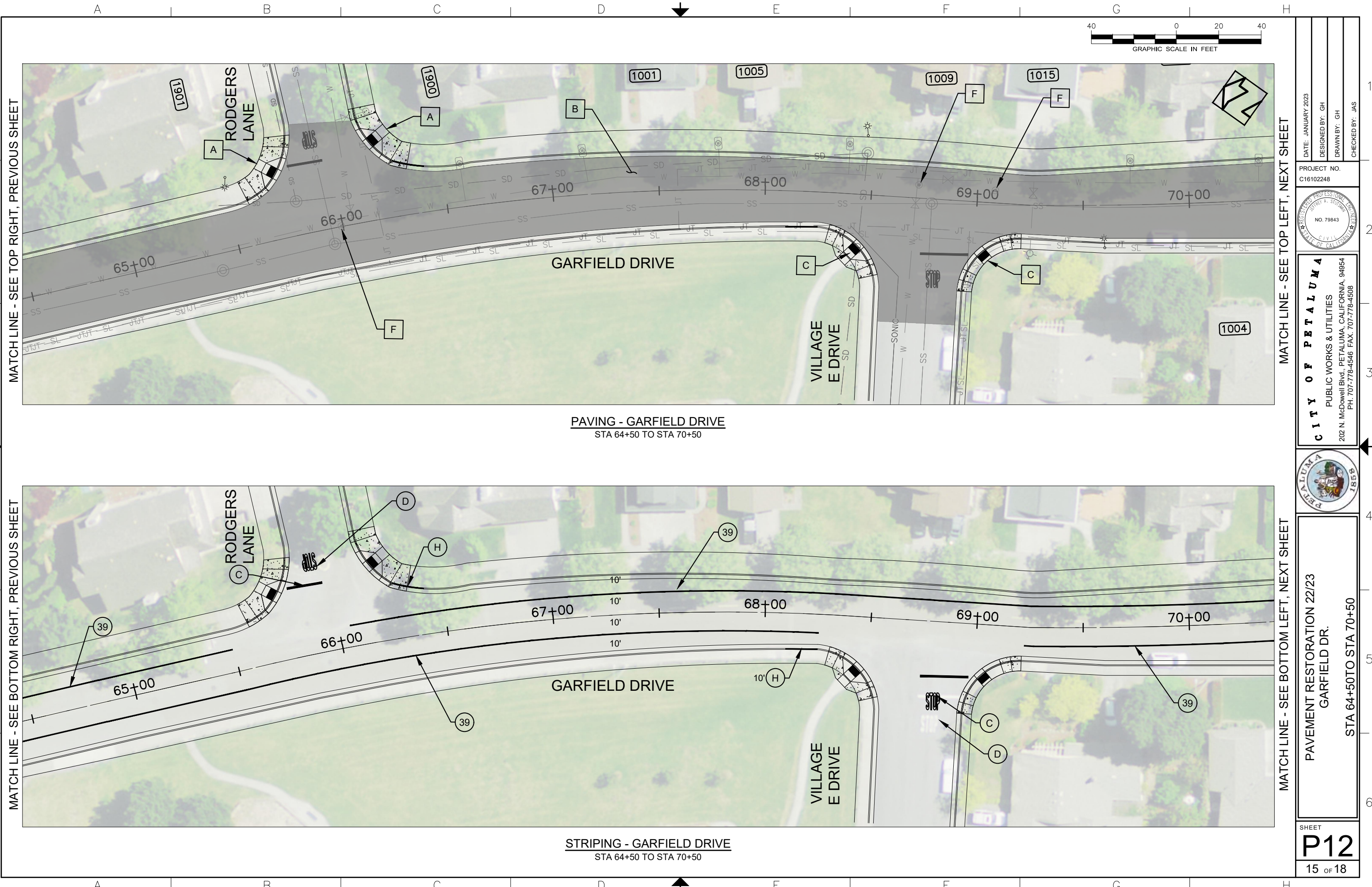

MATCH LINE - SEE TOP RIGHT, PREVIOUS SHEET

MATCH LINE - SEE BOTTOM RIGHT, PREVIOUS SHEET

MATCH LINE - SEE TOP LEFT, NEXT SHEET

MATCH LINE - SEE BOTTOM LEFT, NEXT SHEET

PAVING - GARFIELD DRIVE
STA 64+50 TO STA 70+50

STRIPING - GARFIELD DRIVE
STA 64+50 TO STA 70+50

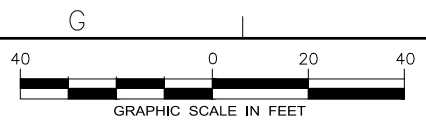

DATE: JANUARY 2023		DESIGNED BY: GH		DRAWN BY: GH		CHECKED BY: JAS	
PROJECT NO. C16102248							
<div></div>							
<div>CITY OF PETALUMA PUBLIC WORKS & UTILITIES 202 N. McDowell Blvd., PETALUMA, CALIFORNIA, 94954 PH. 707-778-4546 FAX. 707-778-4508</div>							
<div></div>							
PAVEMENT RESTORATION 22/23 GARFIELD DR. STA 64+50 TO STA 70+50							
SHEET P12 15 OF 18							

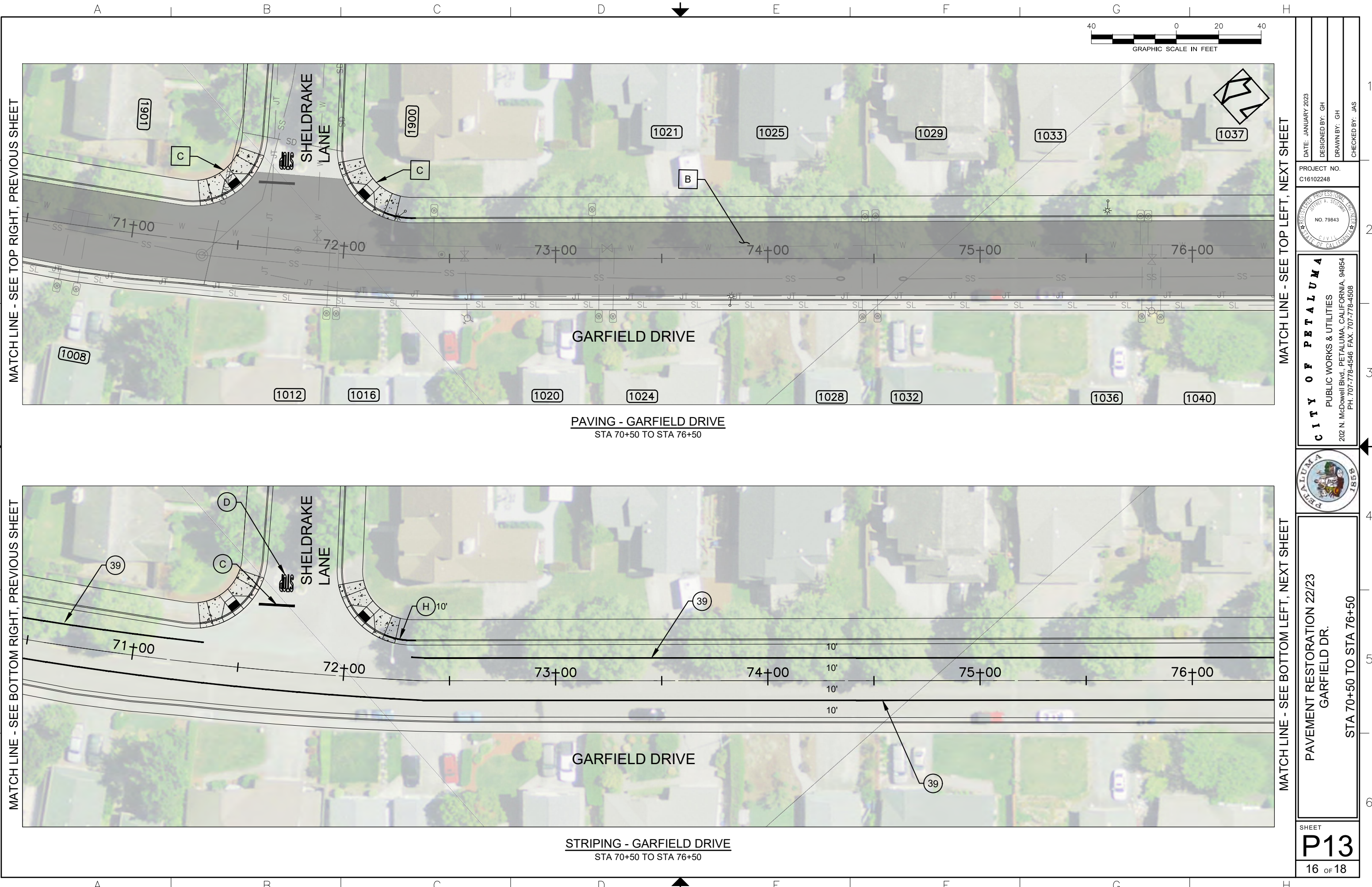

PAVING - GARFIELD DRIVE
STA 70+50 TO STA 76+50

STRIPING - GARFIELD DRIVE
STA 70+50 TO STA 76+50

MATCH LINE - SEE TOP LEFT, NEXT SHEET

MATCH LINE - SEE BOTTOM LEFT, NEXT SHEET

DATE: JANUARY 2023	DESIGNED BY: GH	DRAWN BY: GH	CHECKED BY: JAS
PROJECT NO. C16102248			
			
CITY OF PETALUMA PUBLIC WORKS & UTILITIES 202 N. McDowell Blvd., PETALUMA, CALIFORNIA, 94954 PH. 707-778-4546 FAX. 707-778-4508			
			
PAVEMENT RESTORATION 22/23 GARFIELD DR. STA 70+50 TO STA 76+50			
SHEET P13 16 OF 18			

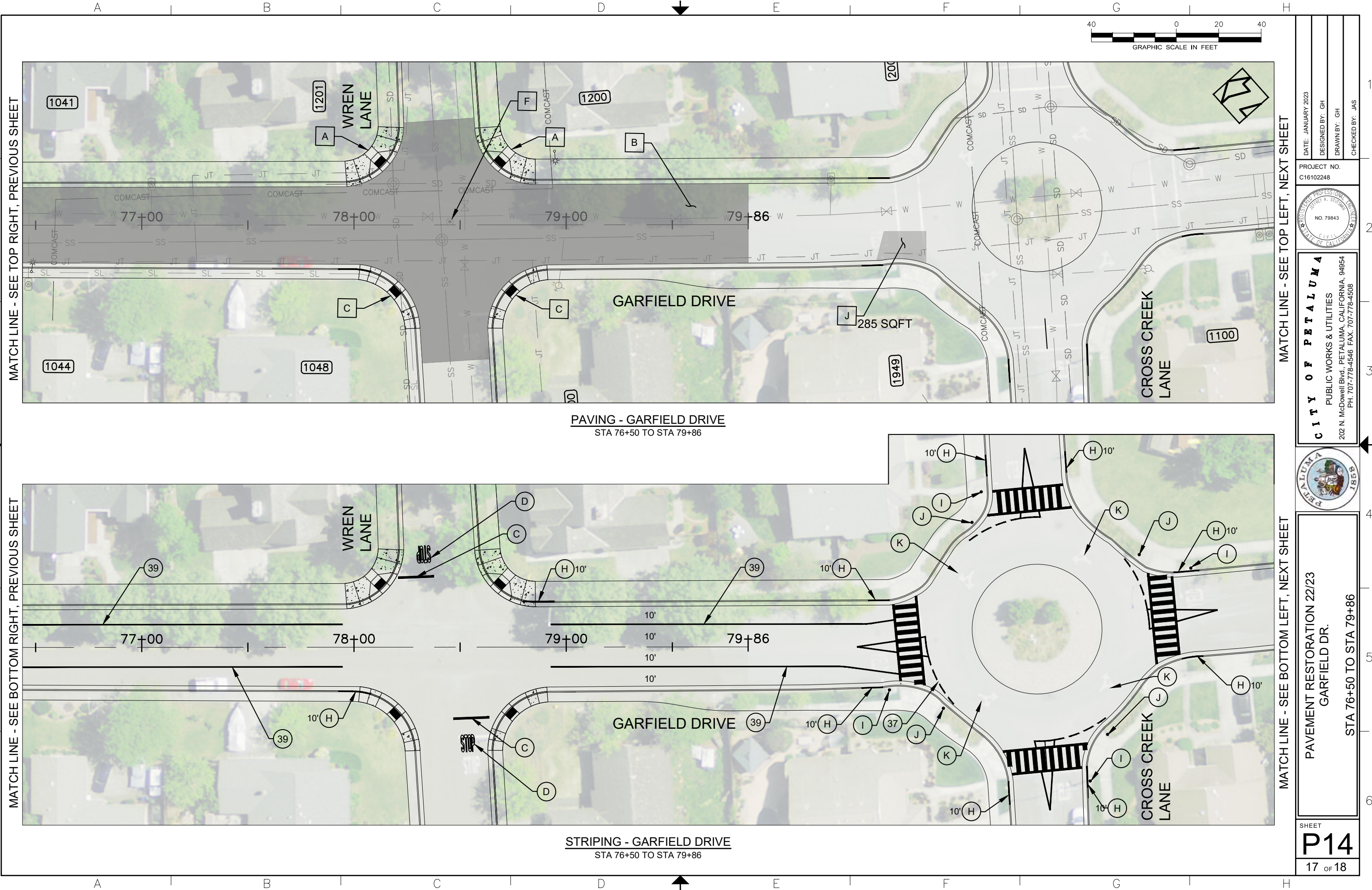

DATE: JANUARY 2023
DESIGNED BY: GH
DRAWN BY: GH
CHECKED BY: JAS

PROJECT NO.
C16102248

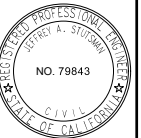

CITY OF PETALUMA
PUBLIC WORKS & UTILITIES
202 N. McDowell Blvd., PETALUMA, CALIFORNIA, 94954
PH. 707-778-4546 FAX. 707-778-4508



PAVEMENT RESTORATION 22/23
GARFIELD DR.
STA 76+50 TO STA 79+86

SHEET
P14
17 OF 18

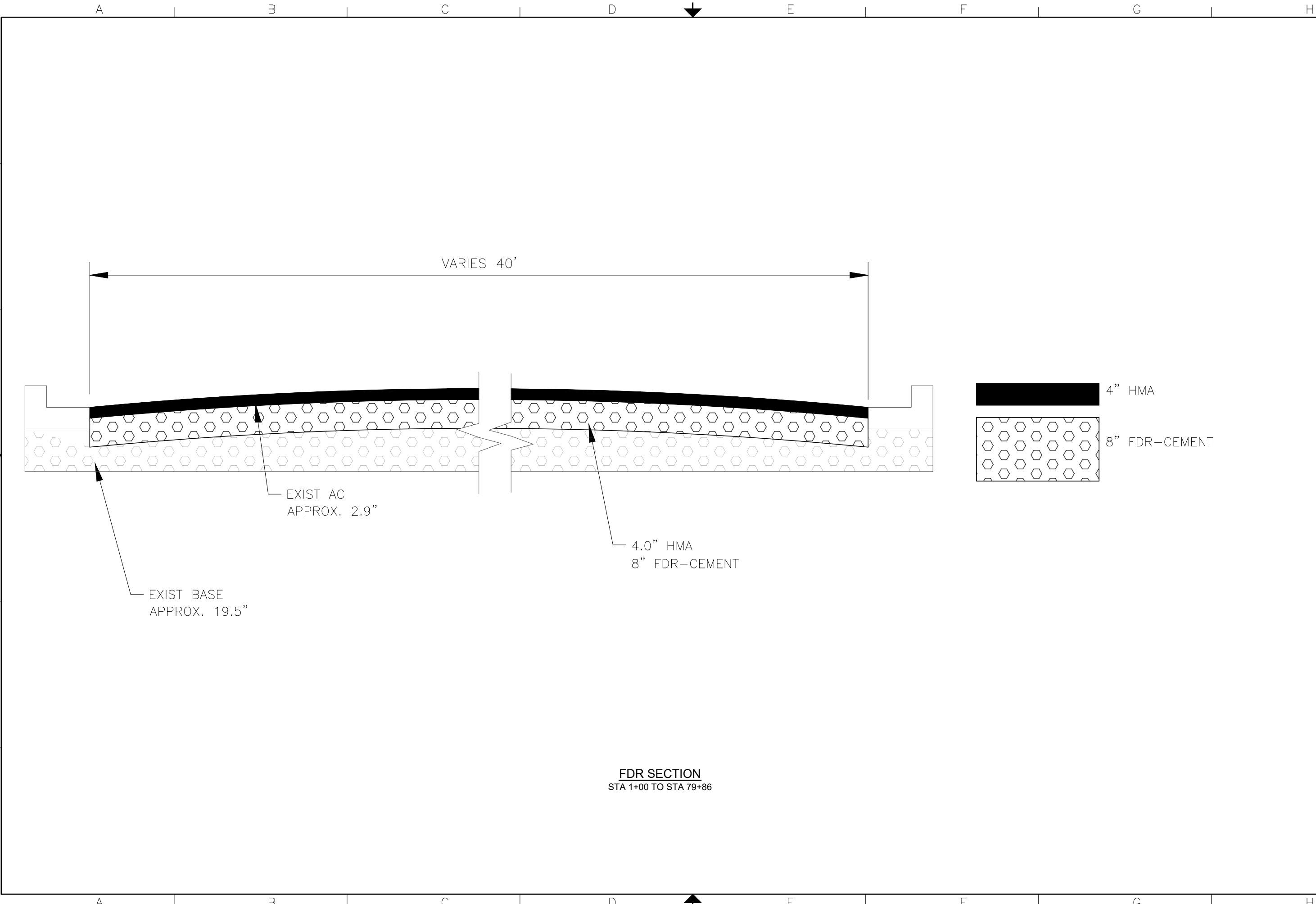

FDR SECTION
STA 1+00 TO STA 79+86

DATE: JANUARY 2023
DESIGNED BY: GBH
DRAWN BY: GBH
CHECKED BY: JAS

PROJECT NO.
C16102248

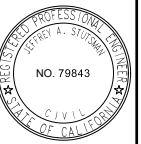

CITY OF PETALUMA
PUBLIC WORKS & UTILITIES
202 N. McDowell Blvd., PETALUMA, CALIFORNIA, 94954
PH. 707-778-4546 FAX. 707-778-4508



PAVEMENT RESTORATION 22/23
GARFIELD DR.
DETAILS